

APPLE CREEK™

CERAMIC FIXTURES

SHOWER CORNER SHELF INSTALLATION GUIDE



Included with your new Apple Creek Corner Shelf:

- Corner shelf
- 2-part epoxy (A+B Tubes)
- Sandpaper
- 2 Foam supports



Position shelf in desired location and lightly outline around the base with a grease pencil. **NOTE:** Do not use grease pencils on porous tile.

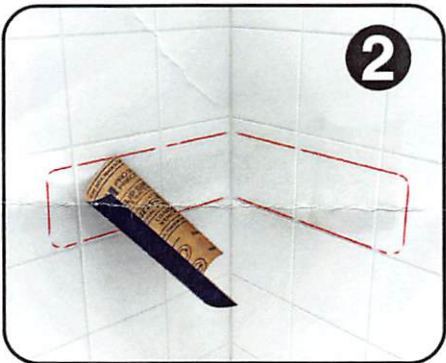

With provided sandpaper, lightly scuff the tile area within the outline, then clean the surface with rubbing alcohol. This will give the adhesive a better bond surface.

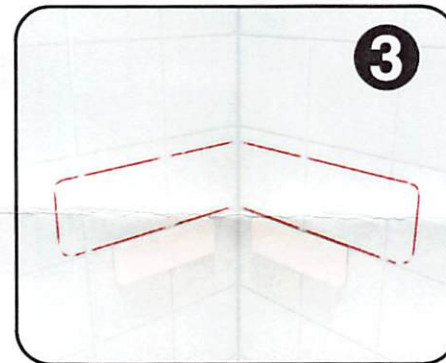

Using the 2 adhesive backed foam pads provided, peel away the protective paper strips and place the pads at the bottom edge of the outline. These pads will be used as a temporary base to help align and support the corner shelf when installed.

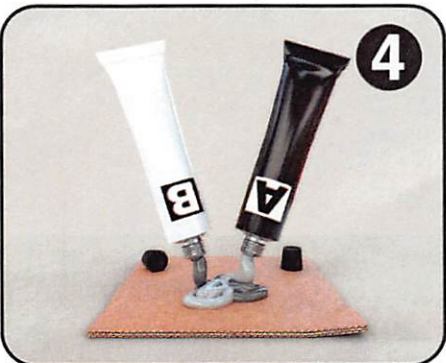

Mix equal portions of the 2-part epoxy provided and mix well. Then apply the epoxy to the rough non-glossy sides of the corner shelf. Use the foam pads as guides and set the corner shelf into position.



Hold the corner shelf firmly for 60-75 seconds to help insure a good bond. Be sure to remove any adhesive that oozes out beyond the base edges. Remove adhesive foam pads and wipe away the grease pencil outline. Once fully cured, caulk the entire perimeter of the corner shelf to seal against water penetration.

Do not set anything on the shelf for at least 24 hours